

TECHNICAL SUPPORT

Call Trojan Battery Technical Support:
United States and Canada: 800-423-6569, dial ext. 3045
International: +1-562-236-3045

Email: technical@trojanbattery.com

On the web: trojanbattery.com/tech-support/

©2021 Trojan Battery Company, LLC. All rights reserved. Unless otherwise noted the TROJAN logo and all trademarks are owned by or licensed to Trojan Battery Company, LLC. Trojan Battery Company is not liable for damages that may result from any information provided in or omitted from this publication, under any circumstances. Trojan Battery Company reserves the right to make adjustments to this publication at any time, without notice or obligation. Please check the Trojan Battery website (www.trojanbattery.com) for the most up-to-date information.
10000380



KEY POINTS FOR INSTALLATION (Cont.)

7. After installing the power communication harness, the next cable(s) to install are the battery-to-battery communication cable(s).

- Each battery must be connected together via the battery-to-battery communication cable(s).
- Attach the battery communication cable to either communication port on top of the battery and then connect the other end to the next battery.

8. For the last battery in the string installation, the Battery Termination Connector Cap should be connected to the last open Communications Port.

KEY POINTS FOR INSTALLATION (Cont.)

9. The final step is to turn each battery in the string back on following the Turn On Sequence.

Turn On Sequence: Press and hold the Status Button. LEDs will successively turn on from left to right. Once all LEDs are on, wait another one to two seconds and release the Status Button.

Care should be taken so that the harness does not rub against sharp metal edges or crimp when installed.

CHARGE INDICATOR MESSAGES

The display will show the battery charge level of all lithium-ion batteries connected to it and rotate through various messages if available. The following information will be shown:

At initial power up of the indicator, the number of batteries connected and powered on in the vehicle will be displayed. Make sure the number displayed equals the number of batteries in your vehicle. If it doesn't, check that each battery is on and that all cables are connected securely.

When connected to a charger, the message will indicate the amount of charge time remaining to full charge.



Remaining Charge Status



Remaining Charge Time

CHARGE INDICATOR MESSAGES (Cont.)

When other alarms or faults are present, the display will rotate between the appropriate alarm and the battery charge status.

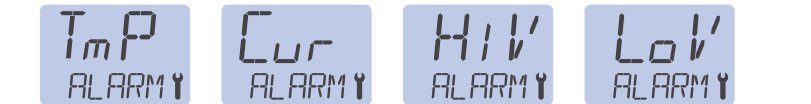

Alarm (Temperature) Alarm (Current) Alarm (High Voltage) Alarm (Low Temperature)

When battery capacity is below 20% state of charge, the message (shown to the right) will appear after the battery charge status. This indicates that the charge of the batteries is getting low and will need to be recharged soon. If this message stays on, it means the state of charge is below 10% and the batteries should be charged immediately.



Low BATLVL

TROJAN TRUST

- Over 200 years of combined engineering expertise.
- Full range of advanced Deep-Cycle Flooded, AGM, Gel, and Li-ion batteries.
- Quality components for reliability and performance.
- Industry-leading return on investment and low cost of ownership.
- Outstanding technical and customer service.



QUICK START GUIDE

TROJAN® BATTERY CHARGE INDICATOR



FEATURES

- Round Two-Line Display
- Water and Dustproof
- Backlight for Easy Viewing
- Dashboard Pop-In Ready



WHAT'S INSIDE BOX

- Battery Charge Indicator
- Termination Connector Cap
- Mounting Bracket
- Quick Start Guide
- Power and Communication Harness

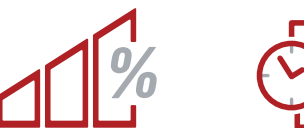

State of Charge %



Charge Time Remaining



Alarm Notification

SAFETY

- Turn batteries off during installation.
- Use cables of appropriate length and gauge. (See Trojan® GC2 48V Lithium-Ion User's Guide for specific cable sizes).
- Wear proper personal protective equipment. (eye protection and gloves)
- Prior to connecting, make sure the charger is off or disconnected.
- Use insulated tools.
- Do not attempt to open the battery case.
- Do not wear jewelry or other metallic objects when handling batteries.
- Review product warning labels and Trojan® GC2 48V Lithium-Ion User's Guide.
- Keep sparks and flames away from batteries. This includes sources of static electricity.
- Use battery lifting strap.

SPECIFICATIONS

Battery charge indicator diameter is based on industry standard size.

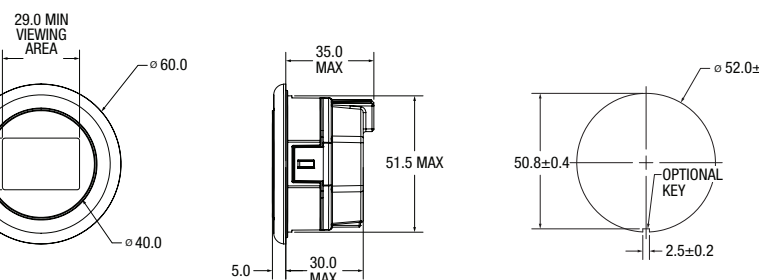

DIMENSIONS mm

INSTALLATION SETUP

The Battery Charge Indicator installation setup requires the 9 ft / 2.7 m power communication cable provided. If a longer cable is needed, please contact your local Authorized Trojan Dealer.

The battery-to-battery cables are ordered separately and are available in two standard lengths. Please contact your local Authorized Trojan Dealer to purchase these cables.

- 1.6 ft / 0.5 m Cable (PN 10000479) Recommended
- 3.2 ft / 1 m Cable (PN 10000480)

- 1* – Battery-to-Battery Communication Cable #1
- 2* – Battery-to-Battery Communication Cable #2
- 3* – Battery Termination Connector Cap

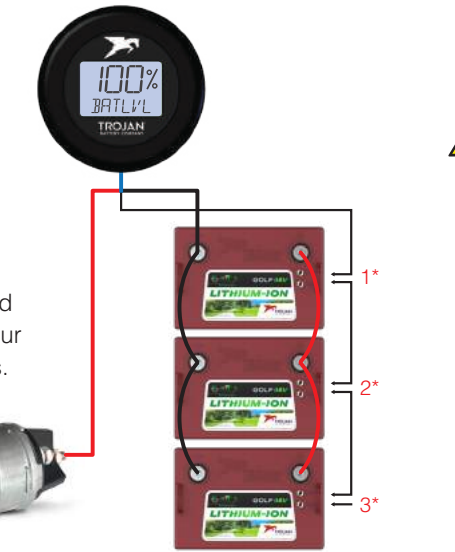

KEY POINTS FOR INSTALLATION

- ⚠ DO NOT INSTALL IN SERIES.
- 1. Turn off each battery in the string by following the Turning Off Sequence.
 - Turning Off Sequence:** Press and hold the Status Button. All LEDs will turn on, then successively turn off from right to left. Once all LEDs are off, wait another two seconds, then release the Status Button.
- 2. Locate the end of the power communication harness that has the four-pin connector and route in through the existing hole or new hole in the vehicle dash and through the mounting bracket.
- 3. Connect the four-pin connector to the back of the Battery Charge Indicator and mount it into the hole in the vehicle dash. Secure with the mounting bracket on back of the vehicle dash.

KEY POINTS FOR INSTALLATION (Cont.)

- 4. Connect the positive or power (red) and negative or ground (black) wires coming out of the harness separately.
- 5. The negative (black) wire should be connected to the main negative terminal of the battery string.
- 6. The positive (red) wire has a replaceable fuse. It should be connected to the key switch of the golf car.
- ⚠ Do NOT connect the positive (red) wire directly to the main positive terminal of the golf car battery string as it will prematurely drain the batteries if the car is not connected to a charger.